

**NOTES:**

- 1.) Building 2 is newer construction
- 2.) Size: ~95,200 sq. ft.
- 3.) Includes Rush Lake Warehouse ~8,500 sq. ft.
- 4.) Total Parking Spaces ~220
- 5.) Total Dock Doors - 8

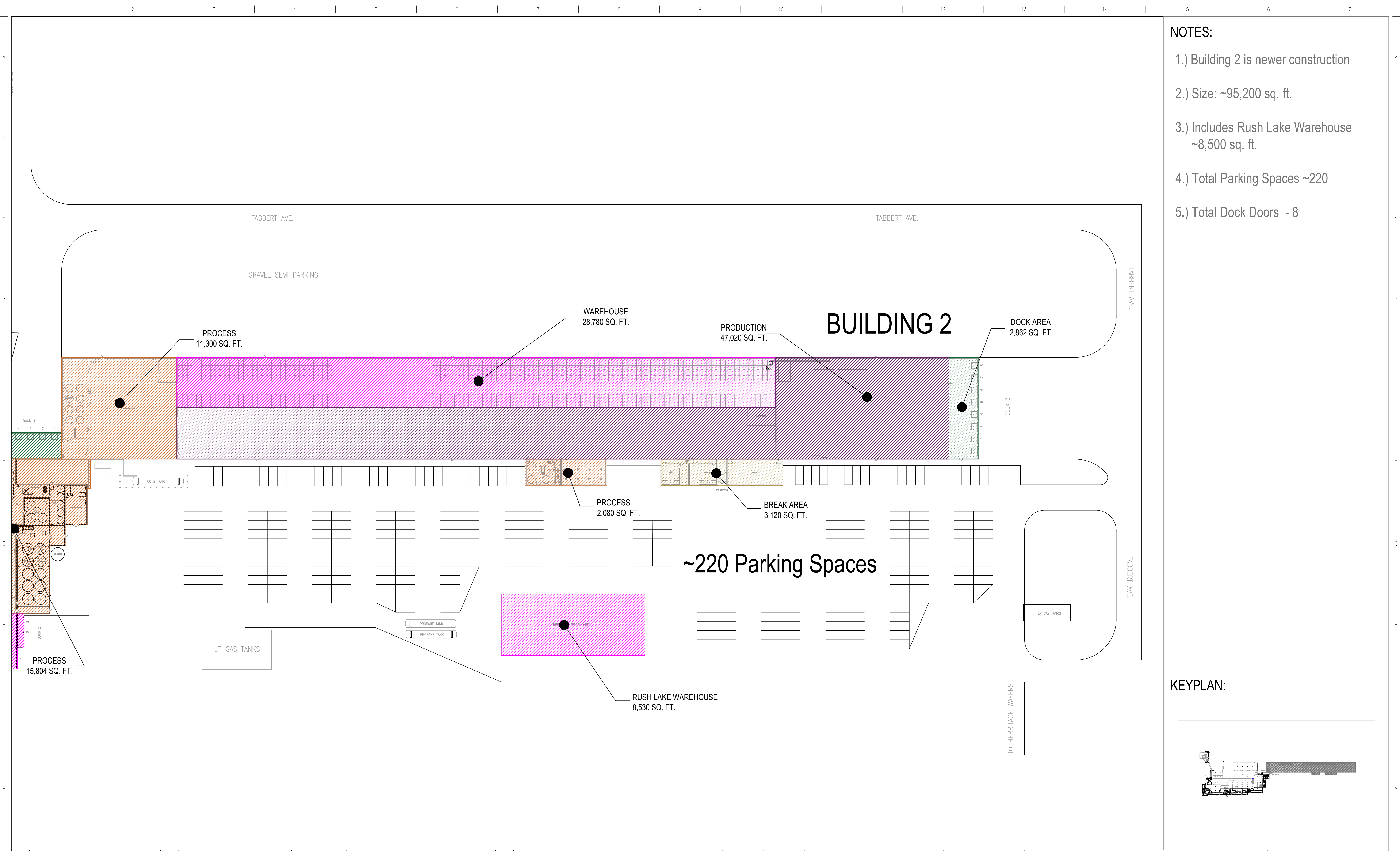

**KEYPLAN:**

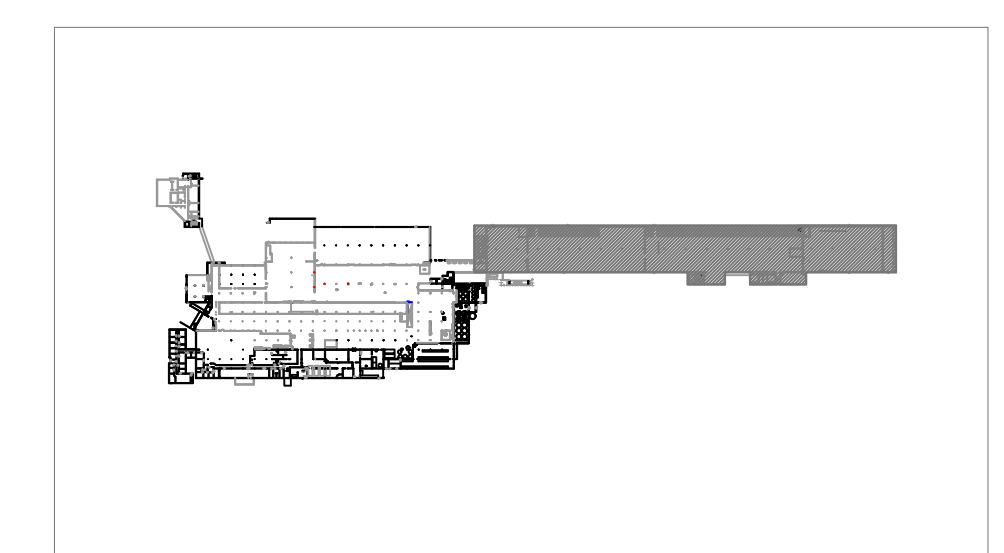

REVISION	BY	APPD. BY	DATE	REVISION	BY	APPD. BY	DATE

NOTICE - THIS DRAWING AND ALL DESIGNS, DETAILS, INVENTIONS OR DEVELOPMENTS COVERED THEREBY ARE CONFIDENTIAL AND THE EXCLUSIVE PROPERTY OF TREEHOUSE PRIVATE BRANDS WHICH RESERVES ALL PATENT OR OTHER RIGHTS. COPYING, REPRODUCTION OR DUPLICATION, IN WHOLE OR IN PART, IS FORBIDDEN UNLESS EXPRESSLY AUTHORIZED BY TREEHOUSE PRIVATE BRANDS. ANY SUCH COPIES SHALL ALSO BE THE EXCLUSIVE PROPERTY OF TREEHOUSE PRIVATE BRANDS. THIS DRAWING AND ANY SUCH COPIES SHALL BE RETURNED WHEN REQUESTED AND USED SUBJECT TO ABOVE CONDITIONS ONLY ON AUTHORIZED COMPANY WORK.

REFERENCE DRAWINGS



DATE 3/24/16  
 MADE BY J.WOOD  
 SCALE NONE  
 APPD. BY  
 PRCL ENGR  
 PRINTED

TREEHOUSE PRIVATE BRANDS  
 RIPON, WI  
 WEST PLANT  
 NEW BUILDING

PLANT Princeton, KY  
 BLDG. NO.  
 DRAWING NUMBER  
 225-0G-L1648B